

Optional



Bluetooth dongle

The **VE.Direct to Bluetooth Smart dongle** allows you to monitor the status of your **Peak Power Pack** and operate it from your smartphone.



Peak Power Pack	PPP-8	PPP-20	PPP-30	PPP-40
Capacity	8Ah	20Ah	30Ah	40Ah
Stored energy	102Wh	256Wh	384Wh	512Wh
Battery type	Lithium-ion (LiFePO4)			
Nominal voltage	12.8V			
Self-discharge when activated	< 13 Ah /year (< 1.4 mA)			
Self-discharge in storage mode	< 6.5 Ah /year (< 0.7 mA)			
Output 1: high capacity "mover"				
Continuous output current	150A			
Maximum output current (10 seconds)	200A			
Short-circuit current	300A			
Safety features	Overload / short-circuiting / temperature / excessive discharge			
Maximum charging current	n.a.	n.a.	15A	20A
Recommended charging voltage	14V (no protection)			
Maximum charging voltage	14.2V (no protection)			
Maximum cable diameter	16mm ² (screw clamps)			
Output 2: on-board power network "domestic"				
Continuous output current	n.a.	30A		
Maximum output current (10 seconds)	n.a.	50A		
Short-circuit current	n.a.	80A		
Safety features	n.a.	Overload / short-circuiting / temperature / excessive discharge		
Maximum charging current	n.a.	n.a.	10A	10A
Recommended charging voltage	n.a.	14V (no protection)		
Maximum charging voltage	n.a.	14.2V (no protection)		
Maximum cable diameter	n.a.	6mm ² (screw clamps)		
Input 1: "car/solar"				
Input voltage range	11 V < Vin < 25 V			
Current limitation	7A			
Input 2: "adapter"				
Output voltage	15V			
Output current	3A			
Input voltage	110 / 230 V 50 / 60 Hz			
General				
Operation	Multifunctional push-button with dual-colour LED			
VE.Direct port	Communication with a smartphone (VE.Direct Bluetooth Smart-dongle required) Connection to a PC (VE.Direct to USB cable required)			
Operating temperature	Battery charging: 0°C to 40°C Battery discharge: -20°C to +40°C Storage: -20°C to +40°C (charging and discharging not possible outside the given temperature range)			
Humidity (no condensation)	Max. 95%			
Weight	2.2kg	3.8kg	5.4kg	8.6kg
Dimensions h x w x d (mm)	92 x 190 x 172	132 x 190 x 172	172 x 190 x 172	212 x 190 x 172
Standards				
Safety	EN-IEC 60335-1, EN-IEC 60335-2-29, EN-IEC 62109-1			
Emission / Immunity	EN 55014-1, EN 55014-2, IEC 61000-3-2, IEC 61000-3-3, EN 50498			

Peak Power Pack

Power on demand



- Lightweight, high-performance battery.
- Space-saving.
- Maintenance-free.
- Built-in solar energy, regulating and charge unit.
- Can be kept in storage for a year (low self-discharge).
- Regulating system for extra-long service life.
- Li-ion system with internal charger.



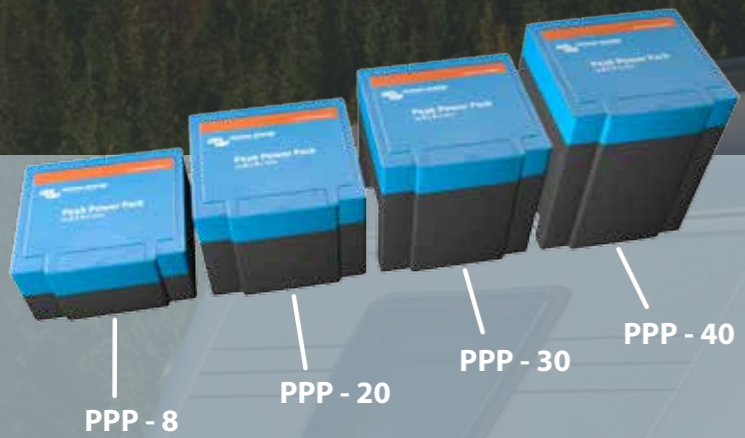

PPP - 8

PPP - 20

PPP - 30

PPP - 40



1

2

Peak Power Pack

The Peak Power Pack is a lithium-ion battery and battery charger housed in a single unit. The Peak Power Pack has been specially designed to provide high current over a short space of time, ideal for a caravan mover. The Peak Power Pack is also extremely suitable for powering your caravan and ensures additional comfort, both on the road and at your holiday destination. It is even possible to monitor the status of the Peak Power Pack from your smartphone (see Bluetooth dongle).

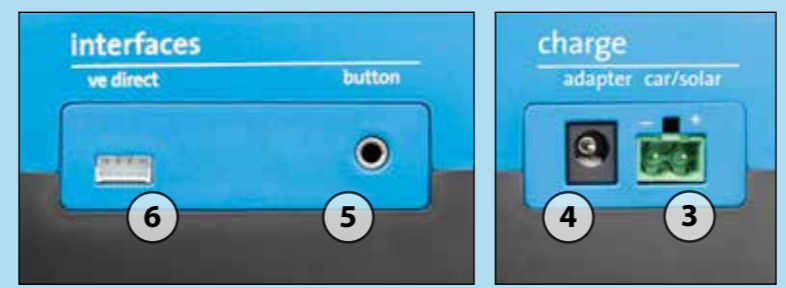

Easy to use

The Peak Power Pack can be charged from your car, and likewise via a solar panel or from the mains connection on your campsite. If you charge the battery whilst driving, the battery will be fully charged for manoeuvring your caravan when you arrive.

Thanks to the cable supplied, the Peak Power Pack is extremely easy to use. A push button operates a built-in LED light with different colours which indicates the status of the battery.

Connections

- 1 200A mover connection
- 2 30A on-board connection
- 3 7A universal charger input
- 4 Connection for 3A universal adapter
- 5 Connection for the operating cable
- 6 VE.Direct connection, e.g. for the Bluetooth dongle

Includes



Means of attachment



110/230V adapter

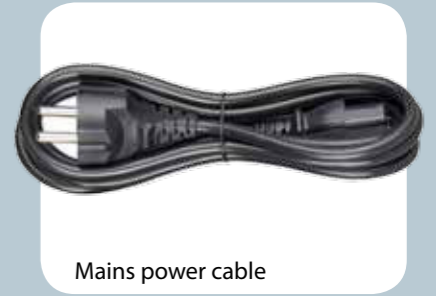

Mains power cable



Cable with push button